



**JR FULTON
& ASSOCIATES, INC.**

COMMERCIAL, INDUSTRIAL AND INVESTMENT REAL ESTATE

**OFFERED BY:
DEBI NEW**



TYPE PROPERTY: RETAIL, BUILD-TO-SUIT PAD SITE

**LOCATION: 2519 N. W. 23rd Street
Oklahoma City, OK 73107**

AVAILABLE AREA: 12,470 SF

**GENERAL INFO: Tenants in the adjacent center:
Supercuts, CSI, Allstate Insurance, H & R Block.
Little Caesars Pizza, next door east of shopping center.
Close to major employment center, Shepherd Mall and OCU.**

**TRAFFIC COUNT: 21,414 vehicles per day. High visibility.
Major improvements to N.W. 23rd Street underway.**

ZONING: C-3, Commercial

FOR LEASE: Negotiable – Call listing broker for more details.

FOR ADDITIONAL INFORMATION CONTACT: DEBI NEW

Cell: 405.821.7104

Office: 405.840.0200

Email: debi@jrfulton.com

www.jrfulton.com

SURVEY
2519 N. W. 23rd St., Oklahoma City, OK

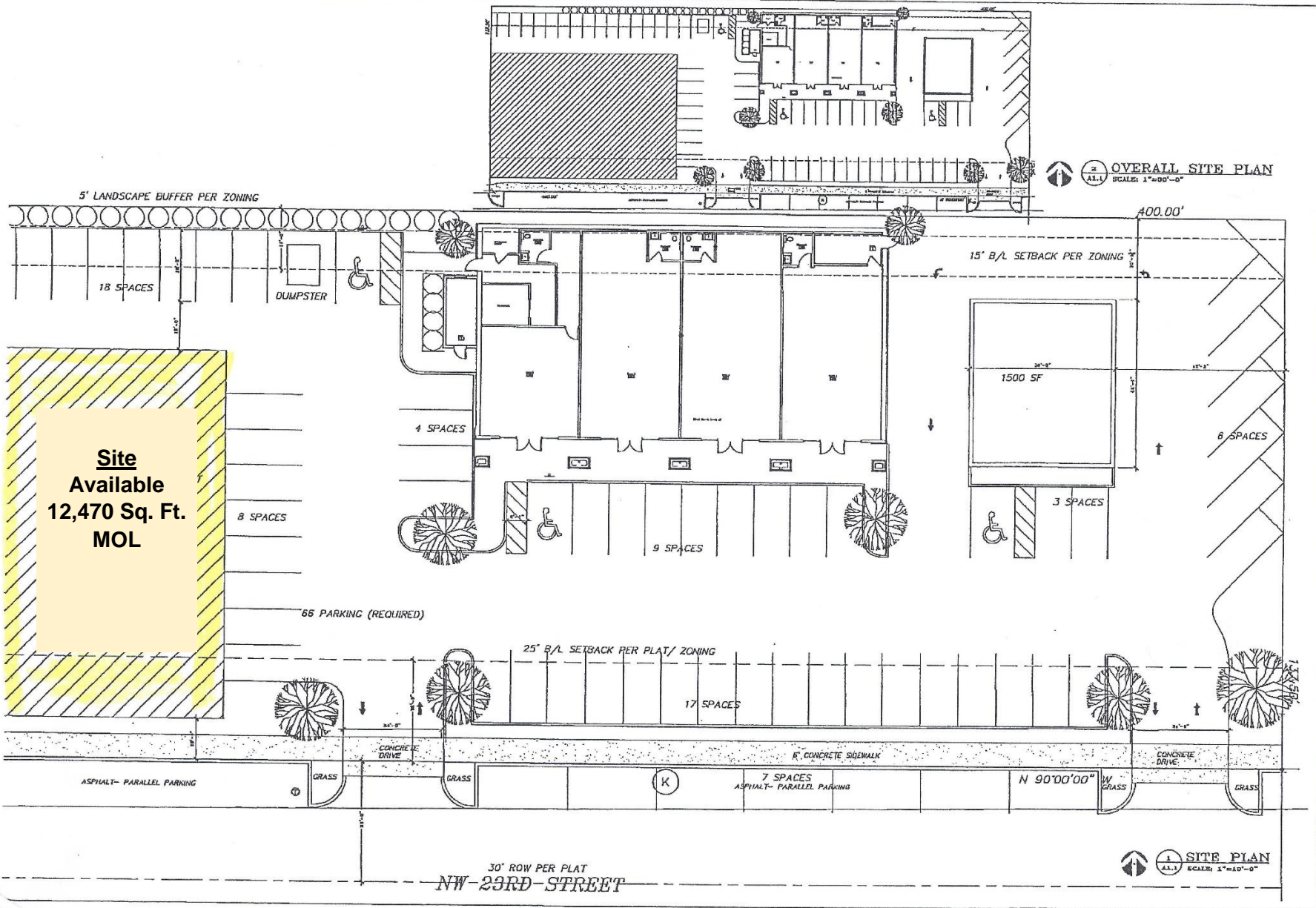

2519
NW 23RD

ALISA J. WEATHERMAN LTD
 8300 SANDALE FOREST RD
 EDMOND, OKLAHOMA 73034
 PH. 545-9378

OFFICE / RETAIL CENTER
 2519 NW 23RD STREET OKC, OK. 73107

20-12-2018

THIS
SITE PLAN

A1.1